

*Local Craft Beer*

*Memorable Moments*

*Old School Fun*



# FLAT STICK PUB

ESTD 2014

*Craft Your Game*

CORPORATE EVENTS  
BIRTHDAYS  
HOLIDAY PARTIES  
*& more!*

**INQUIRE ONLINE AT OUR WEBSITE [WWW.FLATSTICKPUB.COM/PLAN-AN-EVENT/](http://WWW.FLATSTICKPUB.COM/PLAN-AN-EVENT/)**



# KIRKLAND GROUP EVENTS

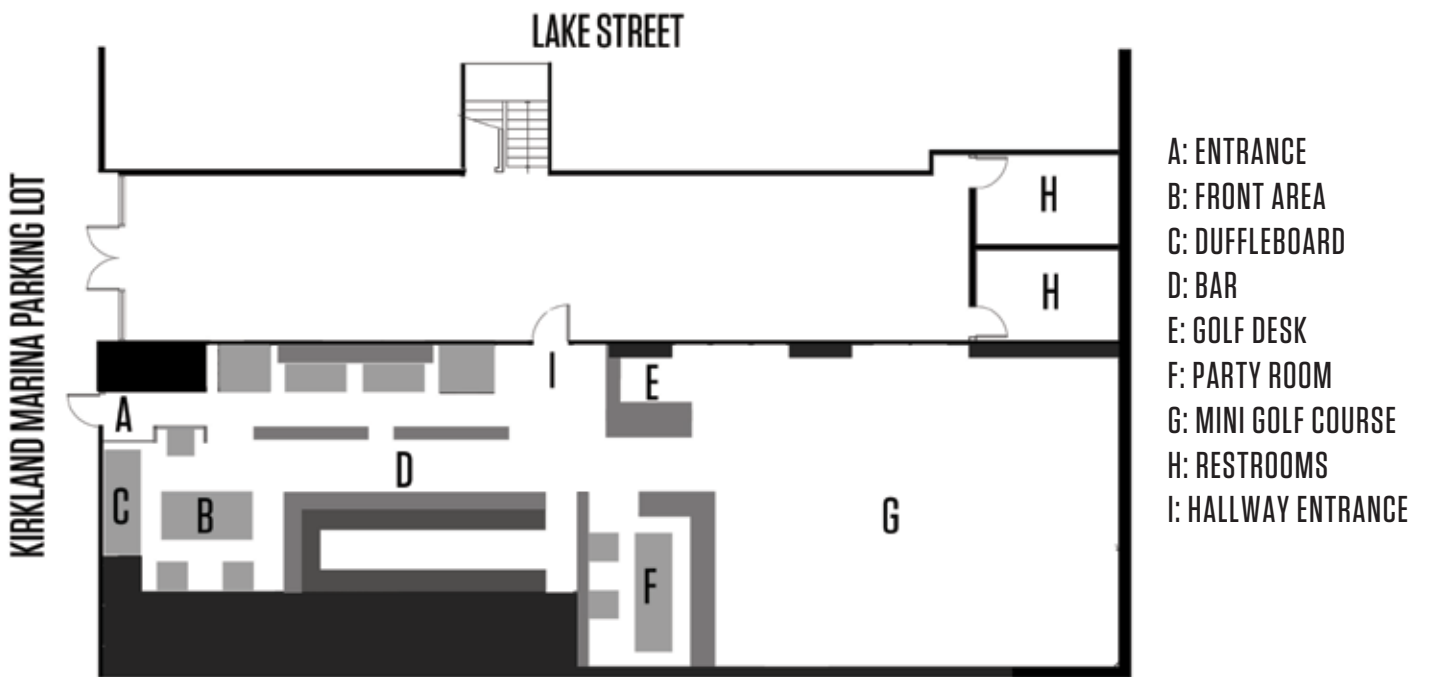

## RATES:

	Sunday-Thursday		Friday & Saturday	
	Open-5pm	5pm-Close	Open-5pm	5pm-Close
Party Room	\$40/hr	\$50/hr	\$50/hr	\$75/hr
Front Area	\$40/hr	\$50/hr	\$50/hr	\$75/hr
Party Room + Mini Golf Course	\$150/hr	\$200/hr	\$200/hr	\$400/hr
Full Pub Buyout	Varies based on specific date and time		Varies based on specific date and time	



# ROOM/PACKAGE DETAILS

## PARTY ROOM

20-25 people

*Includes:* reserved space with your own TV with HDMI hook up and half off mini golf



## PARTY ROOM + MINI GOLF COURSE

25-60 people



*Includes:* reserved space with your own TV with HDMI hookup, entire mini golf course with golf included

## FULL PUB BUYOUT

125-150 people



*Includes:* entire pub and unlimited mini golf

*Other amenities:* board games, duffleboard tables, Nintendo 64, HDMI input for all screens plus microphone access with audio input



# EVENT RESERVATION FAQs

**What kind of drinks do you serve?** We serve locally owned and brewed craft beer, hard cider, wine, and a variety of non-alcoholic drinks. We DO NOT serve hard liquor. No outside beverages (alcoholic or non-alcoholic) are allowed.

**Can we bring in our own food?** You ARE welcome to bring in your own food or catering. We have personal pizzas along with a limited selection of small snacks such as chips, pretzels, nuts.

**Are minors allowed?** Yes, until 7pm daily in the mini golf course and party room area.

**How much does a round of mini golf and duffleboard cost?** Mini golf is regularly \$6 per person and takes around 30-45 minutes to complete. The duration can vary depending on how busy the course is. Duffleboard is free!

**Do you have happy hour?** Yes, Mon-Fri, from 3-6pm. During happy hour, all draft beers, ciders and wines are \$1.50 off.

**How does parking work?** We do not have our own lot but the Marina Park parking lot is right outside our main entrance. It's \$1 per hour from 9am-9pm, Mon-Sat, 4 hours max. There is also street parking available around the pub.

**Do you require a deposit and what is the cancellation policy?** At the time of booking, we do require a NON-REFUNDABLE deposit of \$20 or 20% of the total reservation cost, whichever is greater. The deposit is non-refundable, but if you do need to reschedule, we will apply the paid deposit to a future event reservation as long as we are notified at least 48 hours in advance of the scheduled reservation.

**Do I need to make a tee time for the golf course if I have a room reservation?** Yes, but we will work with you on this at the time of booking. When you book a room, we can set up tee times more than 7 days in advance. If the room is booked at the last minute, tee times will not always still be available but we will do what we can to accommodate your group's request to golf.

**Are you dog friendly?** Yes, we allow well-behaved and leashed dogs!