

*Local Craft Beer*

*Memorable Moments*

*Old School Fun*



# FLAT STICK PUB

ESTD 2014

*Craft Your Game*

CORPORATE EVENTS

BIRTHDAYS

HOLIDAY PARTIES

*& more!*

**INQUIRE ONLINE** AT OUR WEBSITE [WWW.FLATSTICKPUB.COM/PLAN-AN-EVENT/](http://WWW.FLATSTICKPUB.COM/PLAN-AN-EVENT/)



# SOUTH LAKE UNION GROUP EVENTS

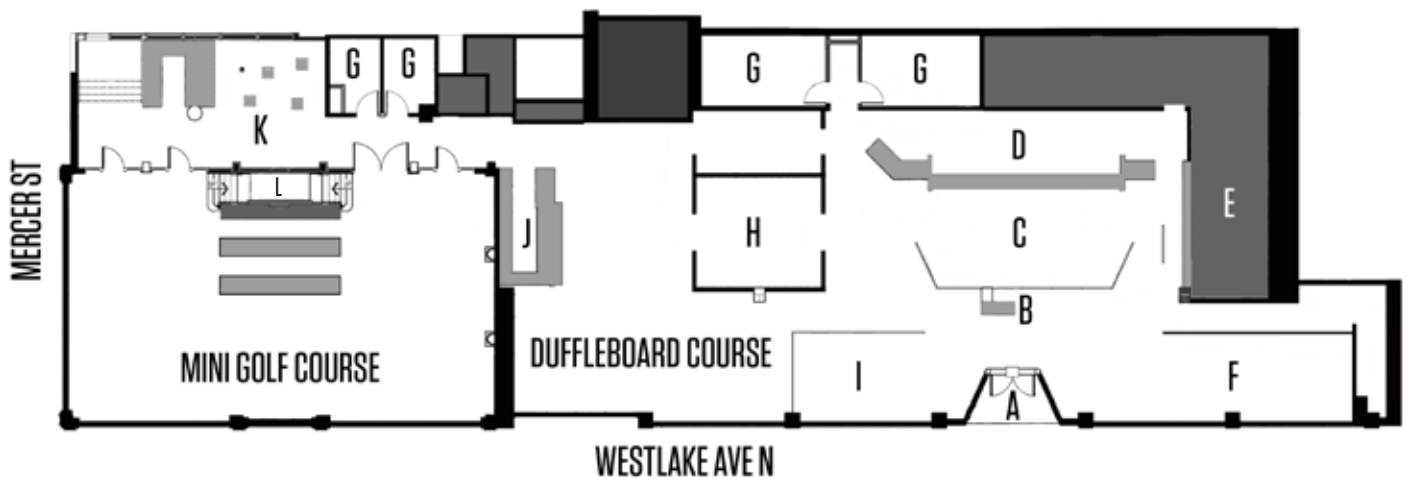

- A: MAIN ENTRANCE
- B: HOST DESK
- C: BAR SEATING
- D: MAIN BAR
- E: KITCHEN
- F: THE WHALE ROOM
- G: RESTROOMS
- H: TABLE SEATING
- I: THE LOCKS ROOM
- J: CADDY SHACK
- K: BACK 9 BAR
- L: OWL'S NEST

## RATES:

	Sunday-Thursday		Friday & Saturday	
	Open-5pm	5pm-Close	Open-5pm	5pm-Close
The Whale Room	\$100/hr	\$100/hr	\$100/hr	\$100/hr
The Locks Room	\$75/hr	\$75/hr	\$75/hr	\$75/hr
Back 9 Bar	\$75/hr	\$75/hr	n/a	n/a
Owl's Nest	\$50/hr	\$50/hr	\$50/hr	\$50/hr
Country Club Package	Varies based on specific date and time		Varies based on specific date and time	
Hole-in-One Package	Varies based on specific date and time		Varies based on specific date and time	

# ROOM/PACKAGE DETAILS

## THE WHALE ROOM

32-50 people

*Includes:* reserved space with your own TV with HDMI hookup available, your own game featuring 'stick putt', half off mini golf and duffleboard



## THE LOCKS ROOM

20-30 people

*Includes:* reserved space with your own TV with HDMI hookup available, your own game featuring 'duffleboard max', half off mini golf and duffleboard



# ROOM/PACKAGE DETAILS

## BACK 9 BAR

10-20 people

*Includes:* reserved space with your own TV with HDMI hookup available, personal bar, half off mini golf and duffleboard

**21+ ONLY**



## OWL'S NEST

10-12 people

*Includes:* reserved lounge space in the upstairs level of the golf room, half off mini golf and duffleboard



# ROOM/PACKAGE DETAILS

## COUNTRY CLUB PACKAGE

60-150 people

*Includes:* exclusive use of mini golf course, back 9 bar, and owl's nest w/ unlimited mini golf and duffleboard, TV with HDMI hookup available and microphone option



## HOLE-IN-ONE PACKAGE

400 people

*Includes:* full pub buyout w/ unlimited mini golf and duffleboard



# EVENT RESERVATION FAQs

**What kind of drinks do you serve?** We serve locally owned and brewed craft beer, hard cider, wine, and a variety of non-alcoholic drinks. We DO NOT serve hard liquor. No outside beverages (alcoholic or non-alcoholic) are allowed.

**Can we bring in our own food?** No outside food allowed. All catering will be available from the kitchen.

**Are minors allowed?** Yes, until 7pm daily in the mini golf course and party room areas. However, the Back 9 Bar is restricted to 21+ all hours of the day.

**How much does a round of mini golf and duffleboard cost?** Mini golf is \$8 per person and duffleboard is \$4 per person and takes around 30-45 minutes to complete. The duration can vary depending on how busy the course is.

**Do you have happy hour?** Yes, Mon-Fri, from 3-6pm. During happy hour, all draft beers, cider and wine are \$1.50 off.

**How does parking work?** Paid visitor parking is available at the Allen Institute building in which we are located. There is also abundant street parking along the surrounding streets, as well as several pay lots to the north of us on Westlake Ave.

**Do you require a deposit and what is the cancellation policy?** At the time of booking, we do require a NON-REFUNDABLE deposit of \$20 or 20% of the total reservation cost, whichever is greater. The deposit is non-refundable, but if you do need to reschedule, we will apply the paid deposit to a future event reservation as long as we are notified at least 48 hours in advance of the scheduled reservation.

**Do I need to make a tee time for the golf course if I have a room reservation?** Yes, but we will work with you on this at the time of booking. When you book a room, we can set up tee times more than 7 days in advance. If the room is booked at the last minute, tee times will not always still be available but we will do what we can to accommodate your group's request to golf.