

Local Craft Beer

Memorable Moments

Old School Fun



# FLAT STICK PUB

ESTD

2014

*Craft Your Game*

CORPORATE EVENTS

BIRTHDAYS

HOLIDAY PARTIES

*& more!*

INQUIRE ONLINE AT OUR WEBSITE [WWW.FLATSTICKPUB.COM/PLAN-AN-EVENT/](http://WWW.FLATSTICKPUB.COM/PLAN-AN-EVENT/)



# SOUTH LAKE UNION GROUP EVENTS

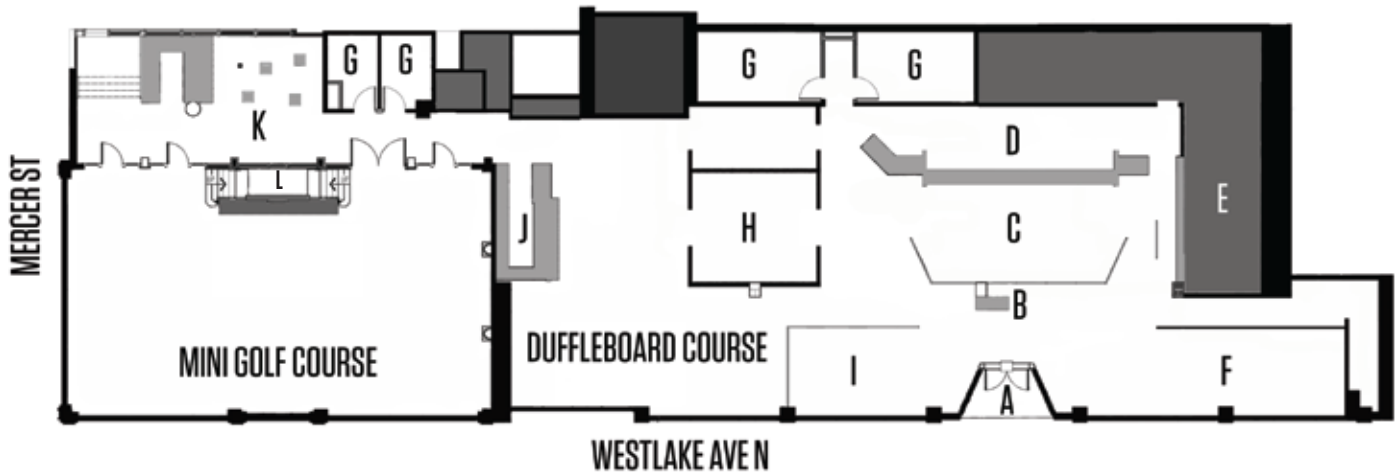

- A:** MAIN ENTRANCE
- B:** HOST DESK
- C:** BAR SEATING
- D:** MAIN BAR
- E:** KITCHEN
- F:** WHALE ROOM
- G:** RESTROOMS
- H:** TABLE SEATING
- I:** LOCKS ROOM
- J:** CADDY SHACK
- K:** BACK 9 BAR
- L:** OWL'S NEST

## RATES

### NEW! HOLE IN ONE PACKAGE

*Includes:*

3 HOUR ROOM RENTAL PLUS 1 ROUND OF GOLF & UNLIMITED DUFFLEBOARD FOR YOU AND YOUR GUESTS!

ROOM	CAPACITY	ROOM ONLY STARTING AS LOW AS..	HOLE IN ONE PACKAGE STARTING AS LOW AS..
Owl's Nest	10	\$25/hr	\$100
Back 9 Bar	20	\$50/hr	\$200
Locks Room	20	\$50/hr	\$200
Whale Room	40	\$100/hr	\$350
Country Club	~100	Varies based on specific date and time	Varies based on specific date and time
Full Pub Buyout	~300	Varies based on specific date and time	Varies based on specific date and time

# ROOM/PACKAGE DETAILS

## THE WHALE ROOM

40 people

*Includes:* reserved space with your own TV with HDMI hookup available, your own games featuring duffleboard max & dufflepong



## THE LOCKS ROOM

20 people

*Includes:* reserved space with your own TV with HDMI hookup available, your own duffleboard table



# ROOM/PACKAGE DETAILS

## BACK 9 BAR

20 people

*Includes:* reserved space with your own TV with HDMI hookup available & personal bar  
**21+ ONLY**



## OWL'S NEST

10 people

*Includes:* reserved lounge space in the upstairs level of the golf room



# ROOM/PACKAGE DETAILS

## COUNTRY CLUB

60-150 people

*Includes:* exclusive use of mini golf course, back 9 bar, and owl's nest w/ unlimited mini golf and duffleboard, TV with HDMI hookup available and microphone option



## FULL PUB BUYOUT

300 people

*Includes:* full pub buyout w/ unlimited mini golf and duffleboard



# EVENT RESERVATION FAQs

**What kind of drinks do you serve?** We serve locally owned and brewed craft beer, hard cider, wine, and a variety of non-alcoholic drinks. We also serve a small selection of batch craft cocktails. No outside beverages (alcoholic or non-alcoholic) are allowed.

**Can we bring in our own food?** No outside food allowed. All catering will be available from the kitchen.

**Are minors allowed?** Yes, until 7pm daily in the mini golf course and party room areas. However, the Back 9 Bar is restricted to 21+ all hours of the day.

**How much does a round of mini golf and duffleboard cost?** Mini golf is \$8 per person and duffleboard is \$4 per person and takes around 30-45 minutes to complete. The duration can vary depending on how busy the course is.

**Do you have happy hour?** Yes, Mon-Fri, from 3-6pm. During happy hour, all draft beers, cider and wine are \$1.50 off.

**How does parking work?** Paid visitor parking is available at the Allen Institute building in which we are located. There is also abundant street parking along the surrounding streets, as well as several pay lots to the north of us on Westlake Ave.

**Do you require a deposit and what is the cancellation policy?** At the time of booking, we do require a NON-REFUNDABLE deposit of \$20 or 20% of the total reservation cost, whichever is greater. The deposit is non-refundable, but if you do need to reschedule, we will apply the paid deposit to a future event reservation as long as we are notified at least 48 hours in advance of the scheduled reservation.

**Do I need to make a tee time for the golf course if I have a room reservation?** Yes, but we will work with you on this at the time of booking. When you book a room, we can set up tee times more than 7 days in advance. If the room is booked at the last minute, tee times will not always still be available but we will do what we can to accommodate your group's request to golf.

**How can I set up a tab?** We are a cashless pub and you'll need a credit card to start a tab. You can start a tab for your group, have all of your guests open their own tabs or provide your guests with drink tickets.

**What are drink tickets and how can my group use them?** Drink tickets have no monetary value and don't affect the price of the beverages we have. They're a way for hosts to limit how many drinks are put on tab. Our beers, wine and cider are on average \$6.50. Drinks are charged on a per consumption basis the day of your event and bartenders will only add drinks to the tab once given a drink ticket. There's no charge if you'd like to use drink tickets for your party

**What is considered a valid ID?** All guests must present valid identification (US driver's license or ID, passport, passport card, or military ID) in order to be served alcohol and to be admitted after 7PM. A valid ID in the state of WA means that it has to be a US/Canadian license OR it must be a passport. Unfortunately, we cannot accept government issued IDs from other countries, only passports.